

RZ67 SPECIAL INSTRUMENT AND TOOL

1. RZ-1 Bayonet ring flatness measuring stand

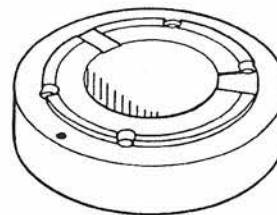

2. RZ-2 Block gauge

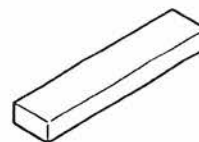

3. RZ-3 Finder focus adjustment driver

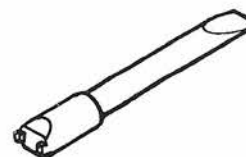

4. RZ-4 Height gauge for the finder screen hook

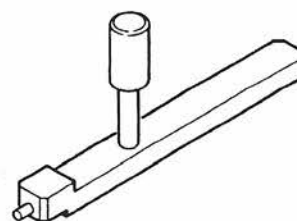

5. RZ-5 Signal bar gauge

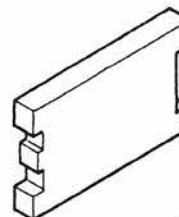

6. RZ-6 RZH-signal bar gauge and screen mask change-over bar gauge

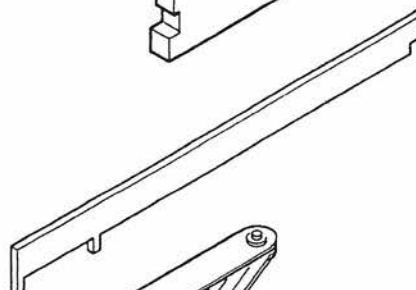

7. RZ-7 GS-1.5 Snap ring spanner

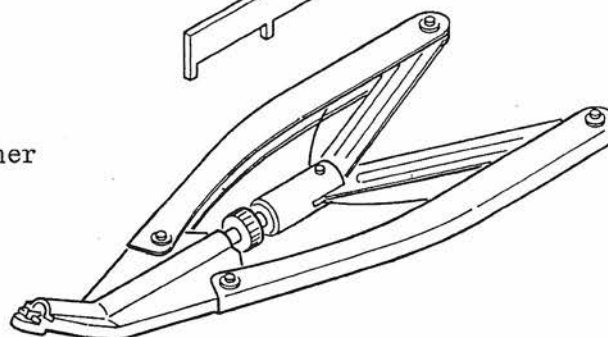

8. RZ-8 R-M lever screw driver

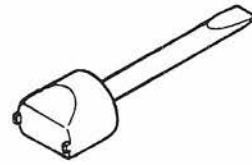

9. R-11 Spanner for RS-1172 nut

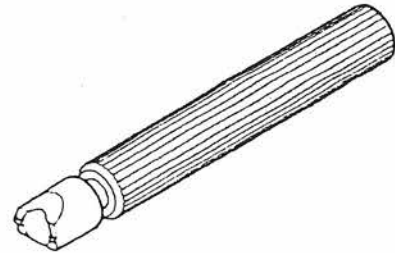

10. R-5 Body cocking angle gauge

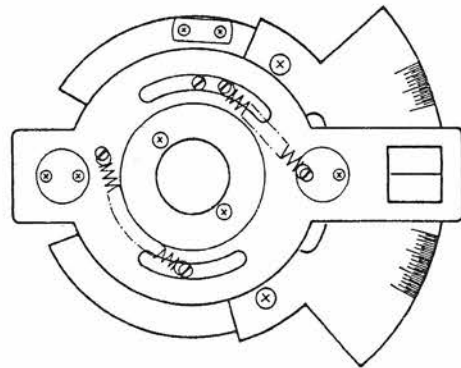

11. SLS-19 Dummy battery for checking battery leakage

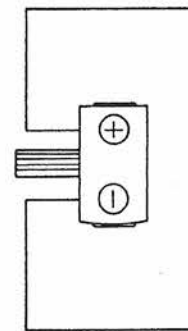

Mamiya RZ67 PROFESSIONAL

PARTS CATALOG

Mamiya
CAMERA CO., LTD.
TOKYO, JAPAN

P.C.82-9-RZ

Mamiya RZ67 PROFESSIONAL



Contents

	Page
Camera Body	1
120 Roll Film Holder RZ	27
220 Roll Film Holder RZ	39
Focusing Hood RZ	45

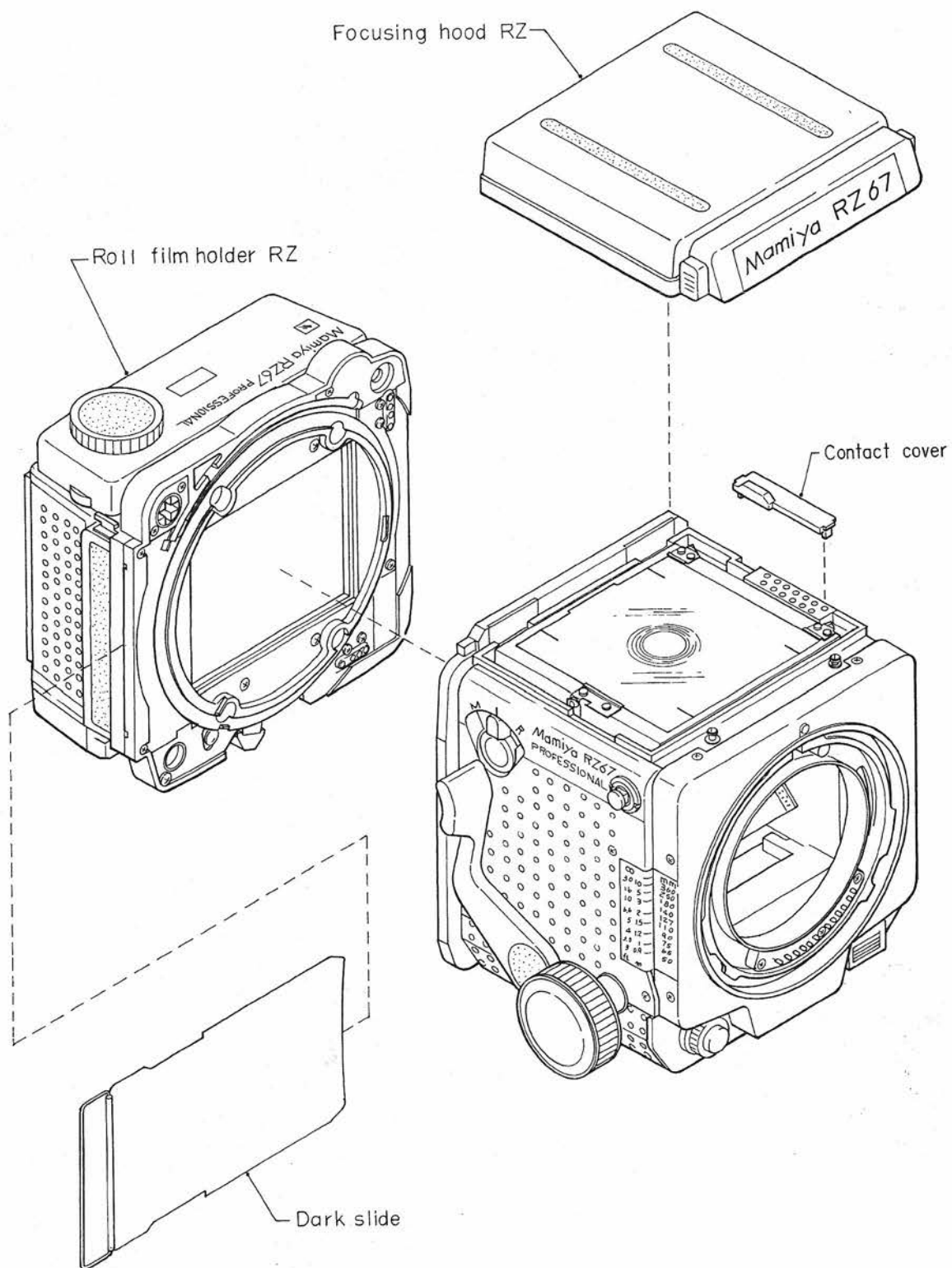

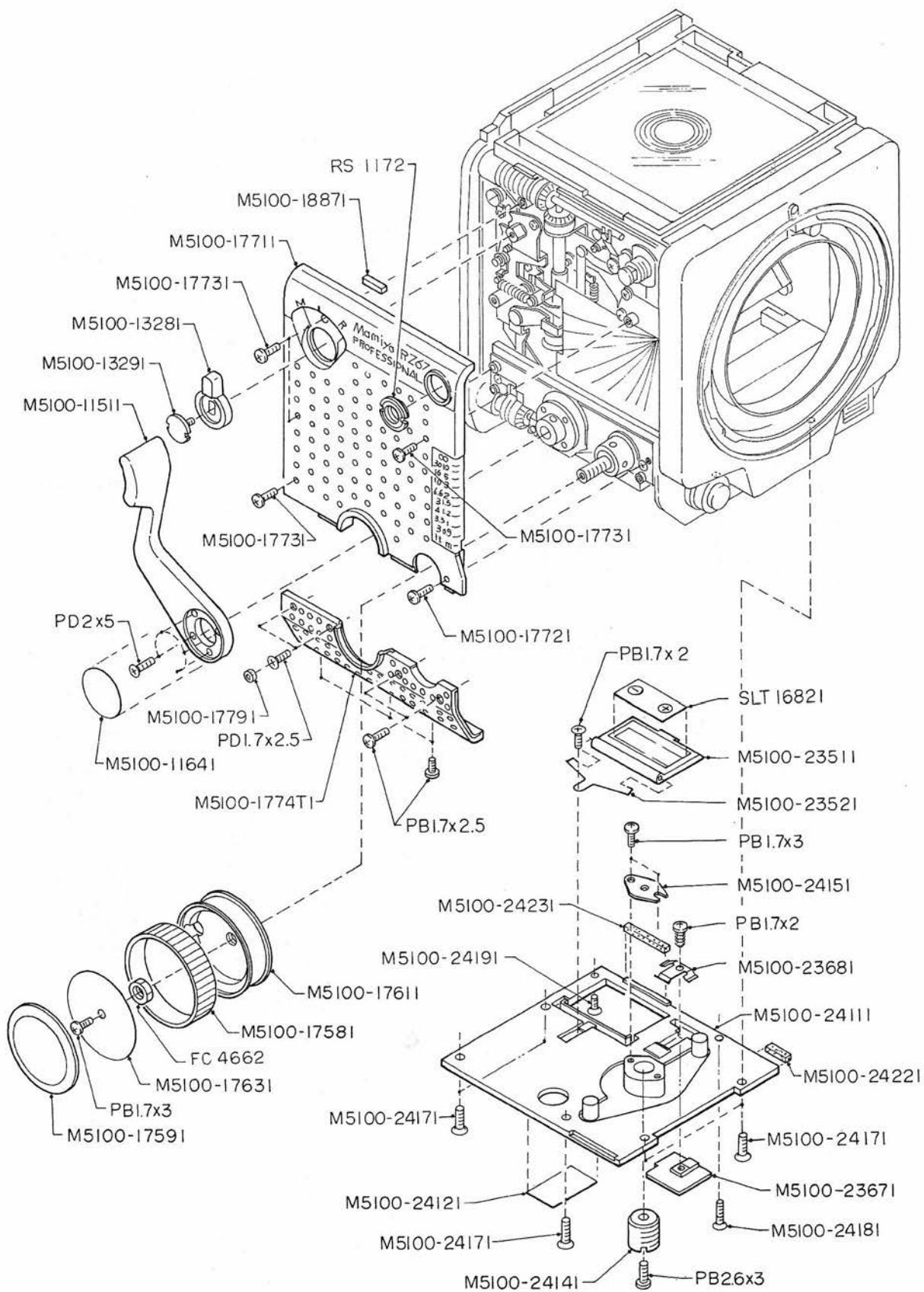

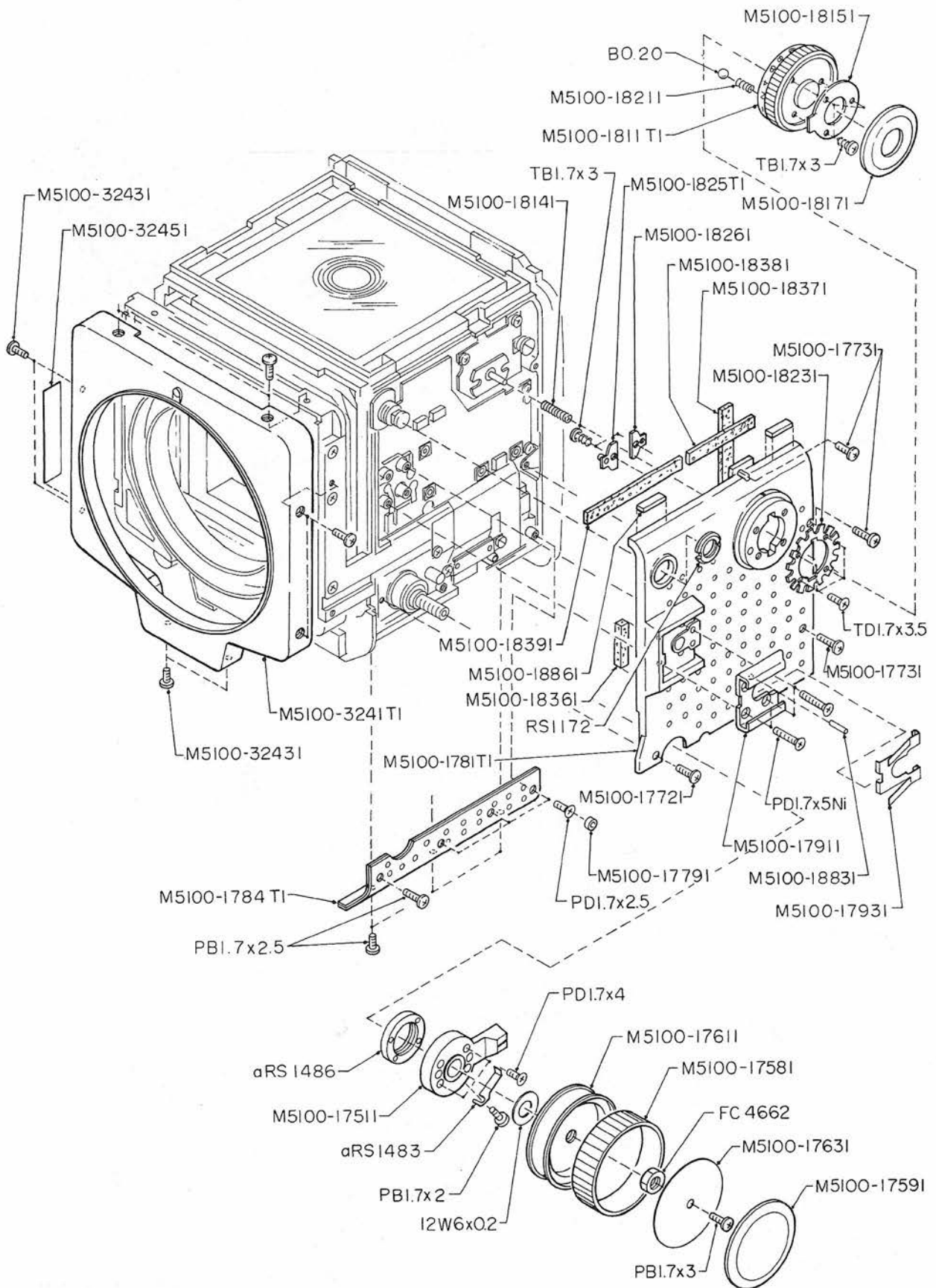

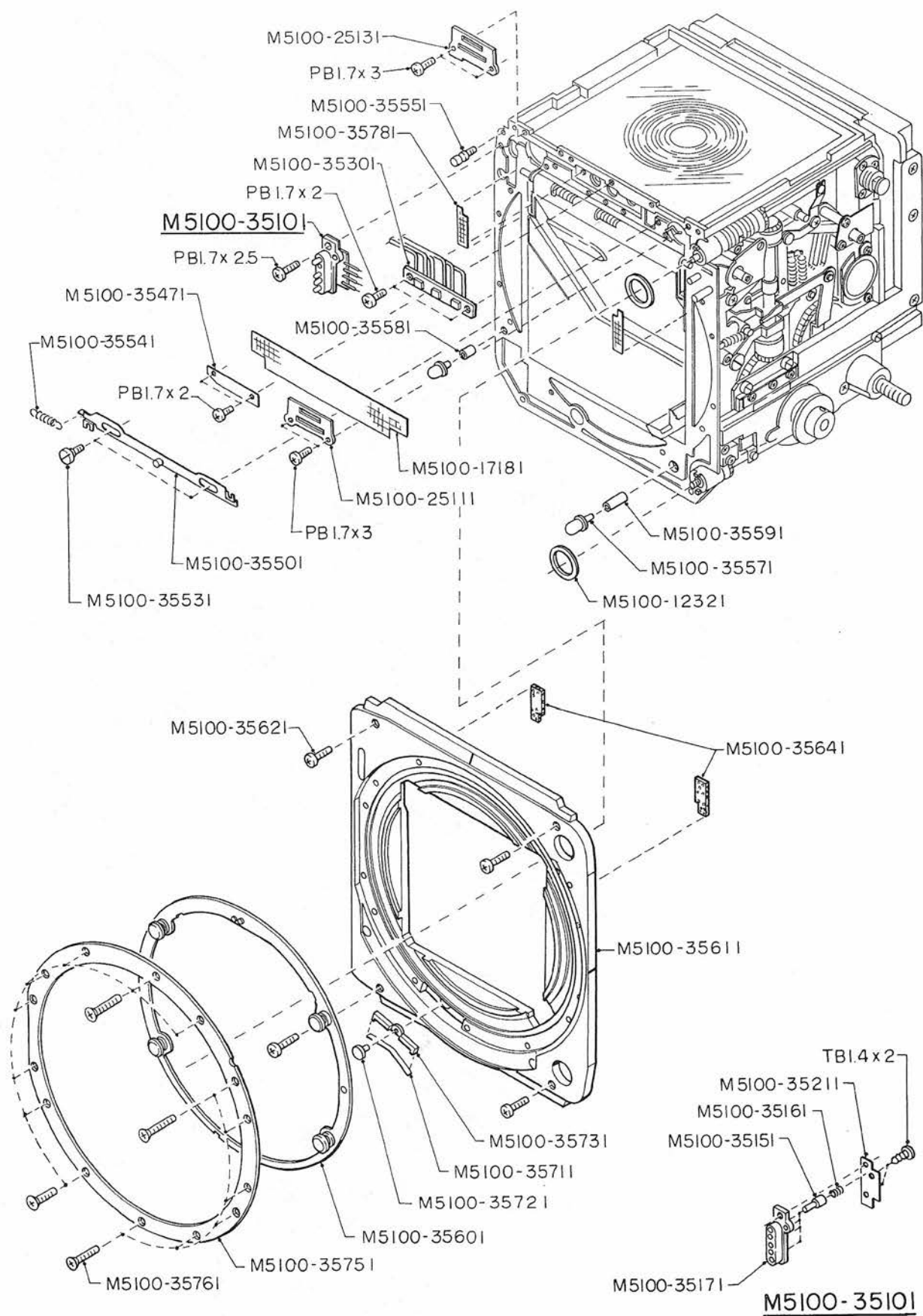

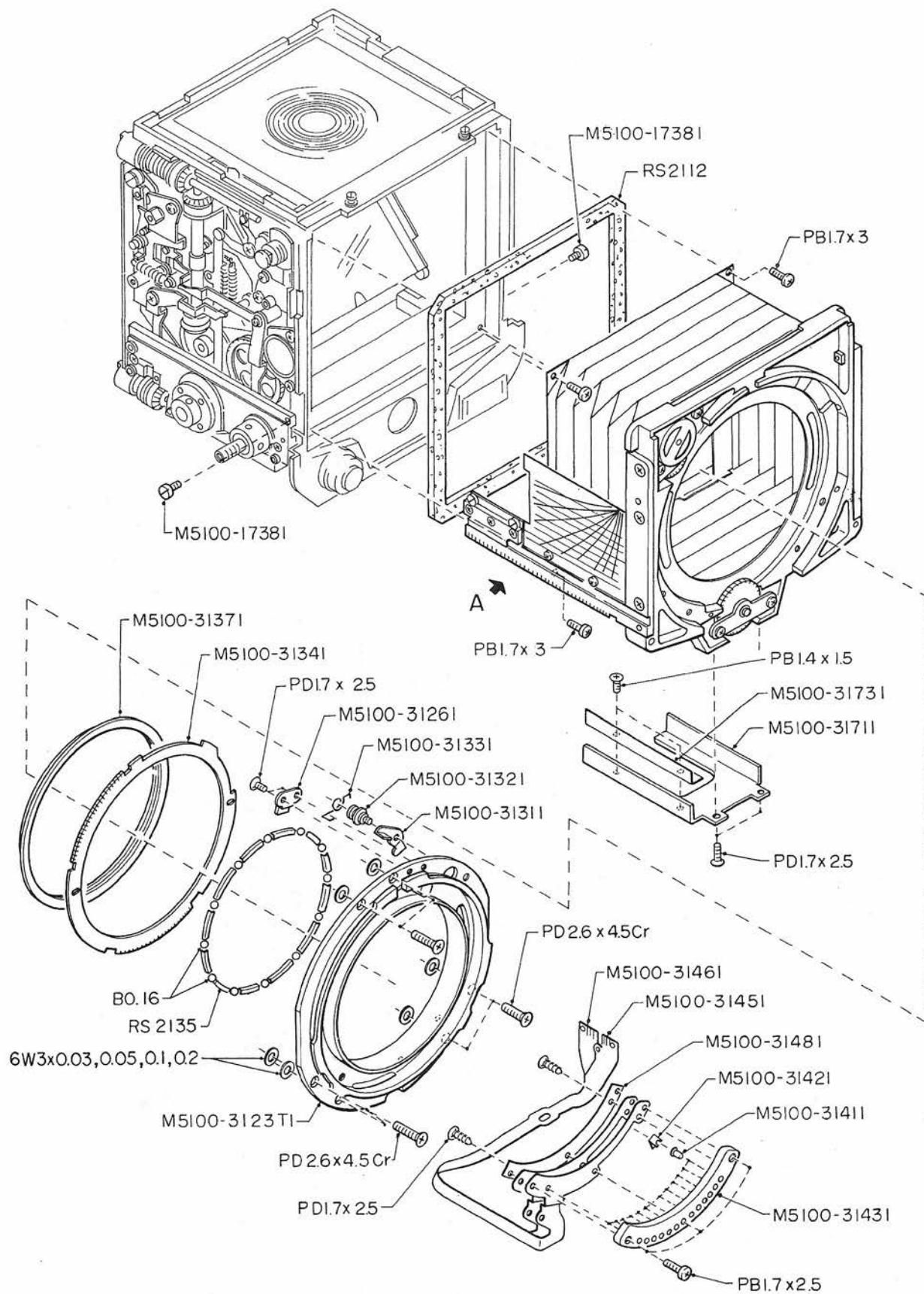

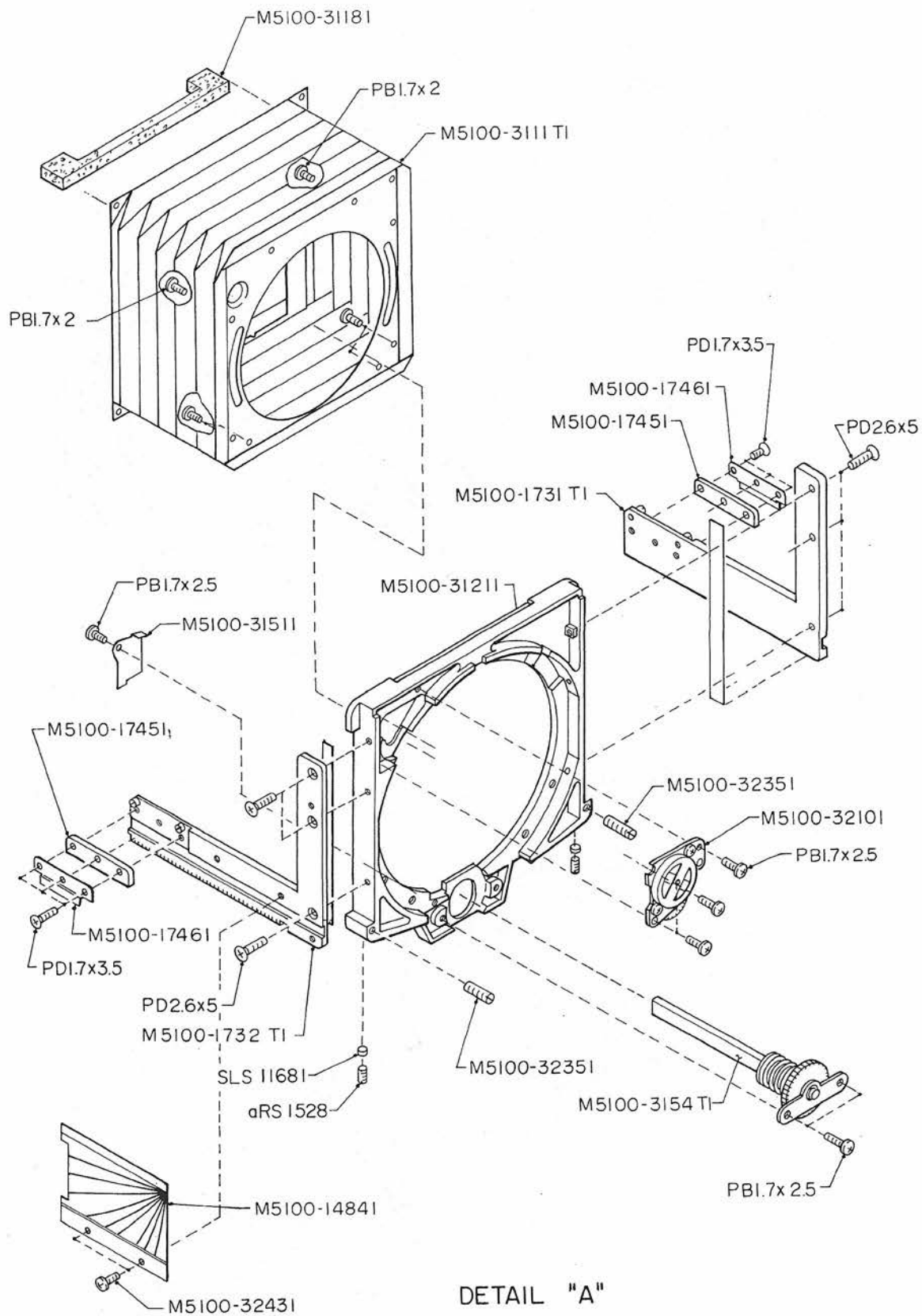

DETAIL "A"

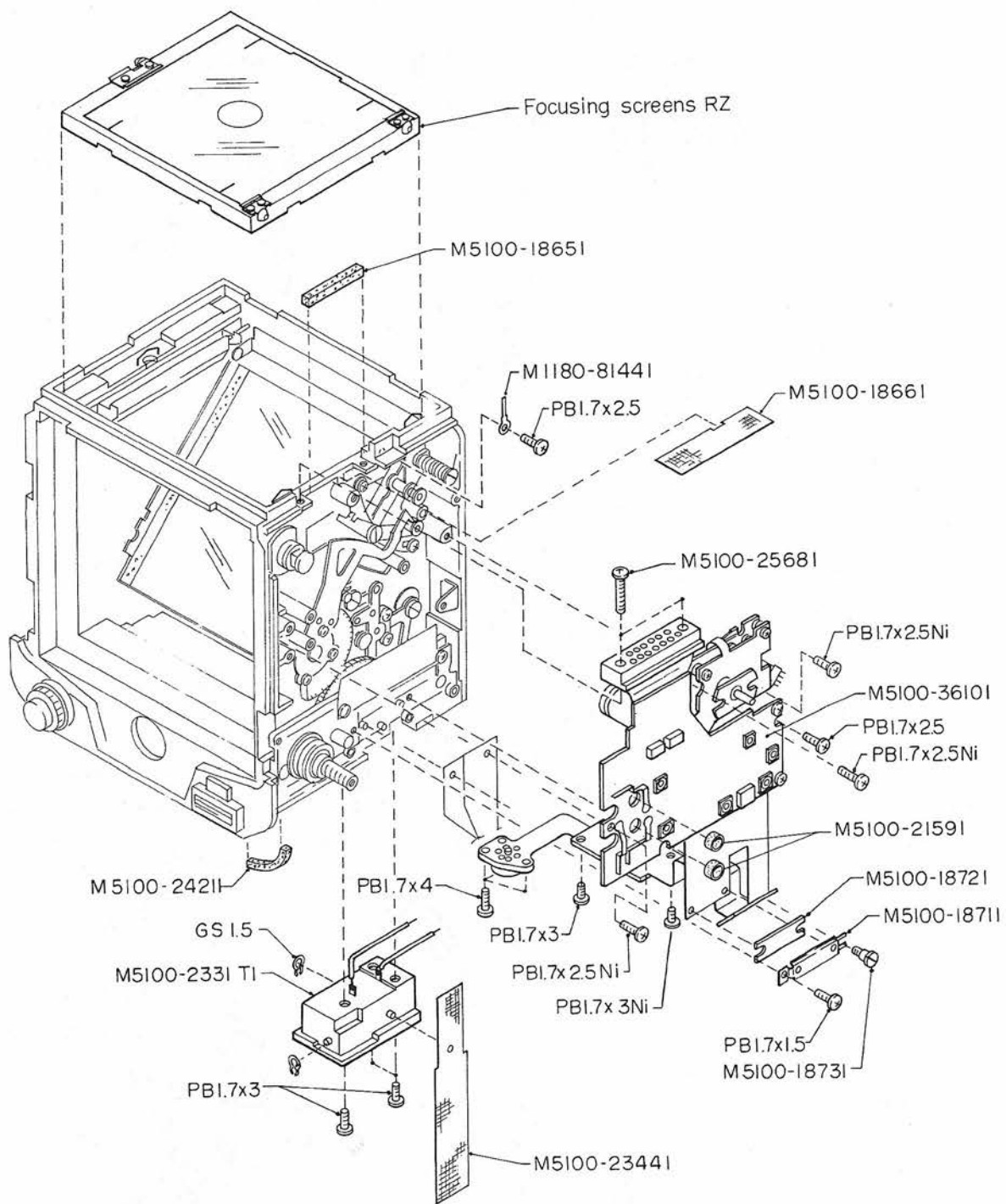

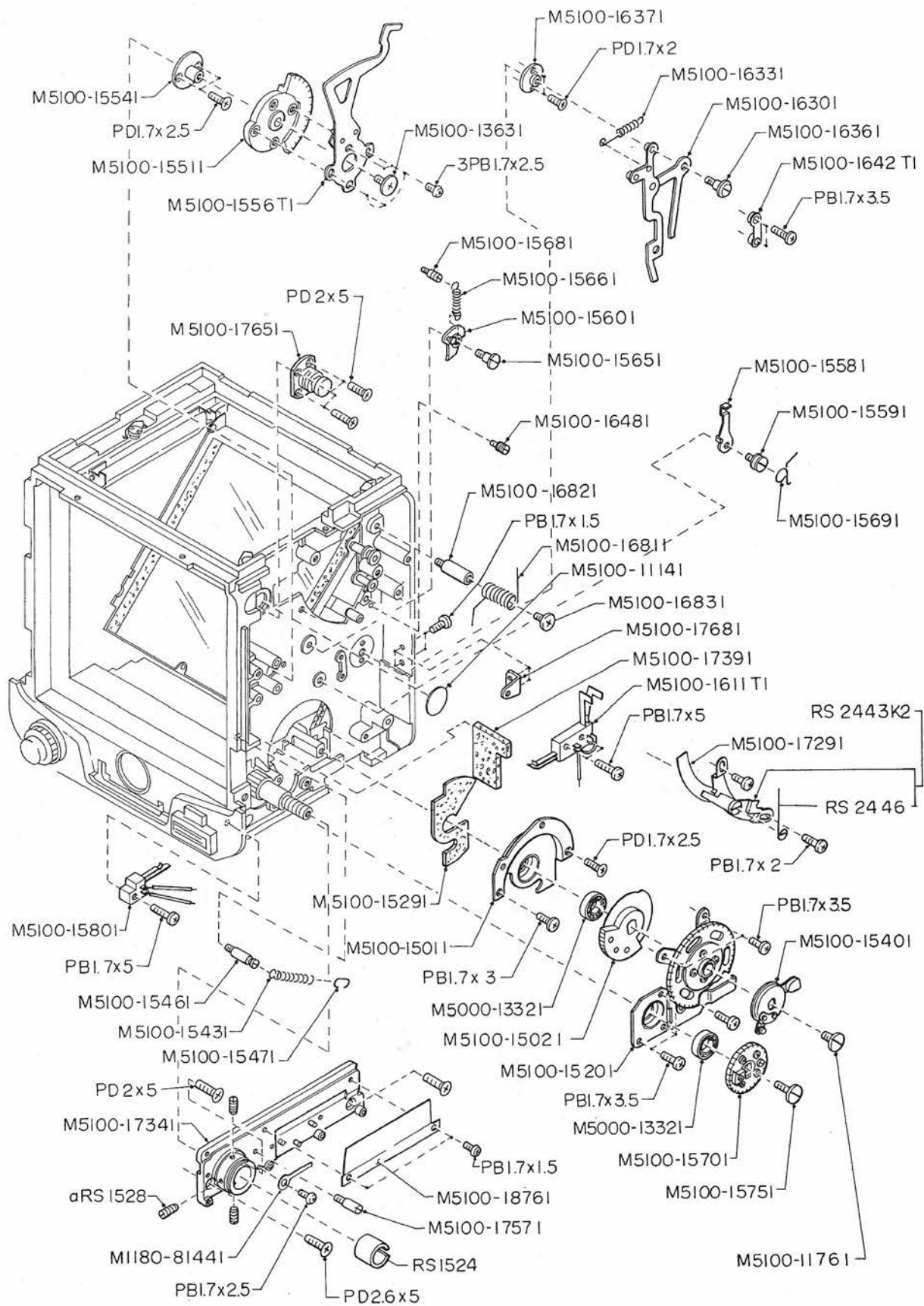

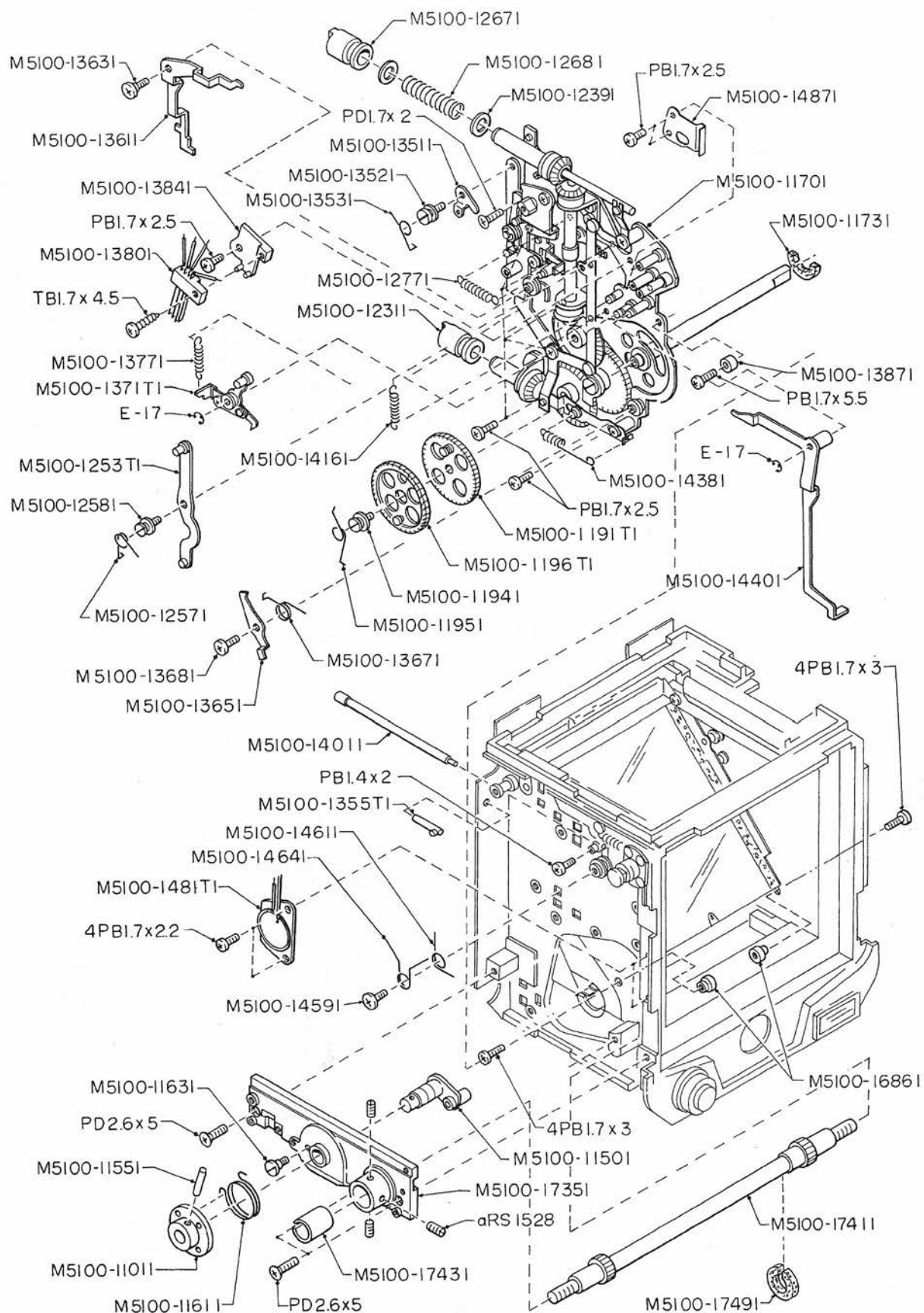

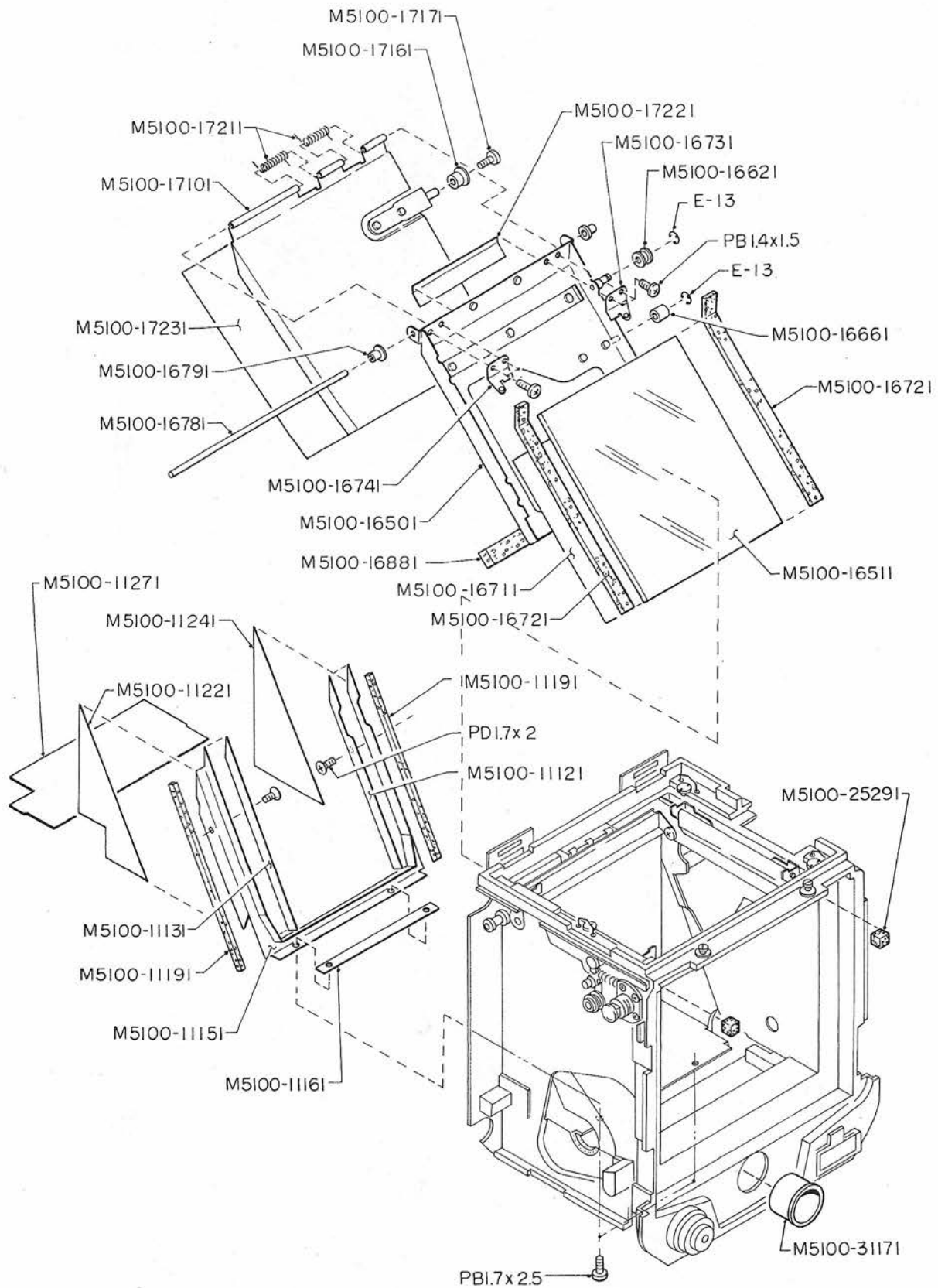

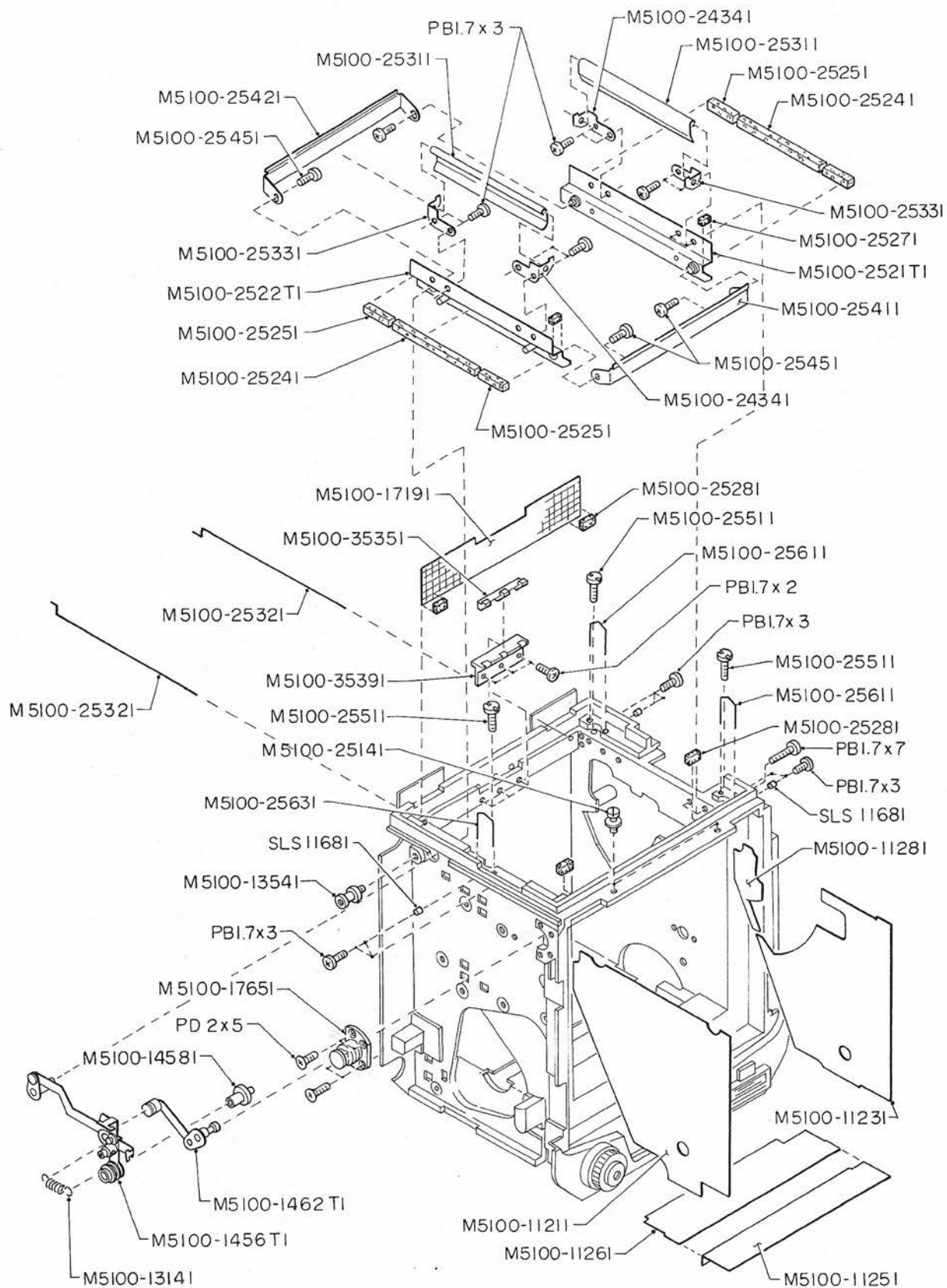

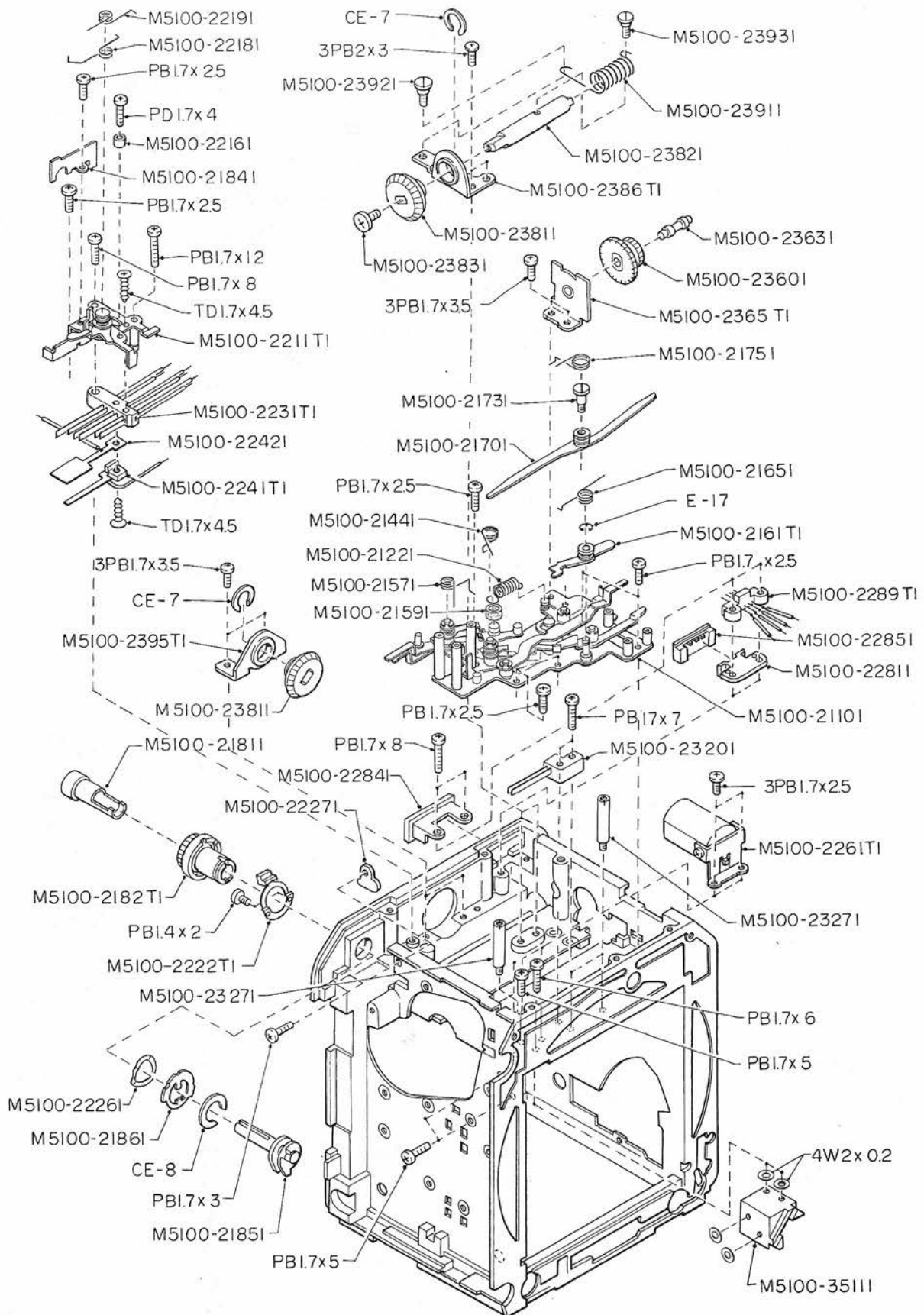

Parts No.	Description	Pcs.	Ref. Page
M5100-11011	Hub	1	9
M5100-11121	Light baffle	1	10
M5100-11131	Light baffle	1	10
M5100-11141	Light baffle	1	8
M5100-11151	Frame	1	10
M5100-11161	Light baffle	1	10
M5100-11191	Sealing strip	2	10
M5100-11211	R.A. leatherette	1	11
M5100-11221	R.A. leatherette	1	10
M5100-11231	R.A. leatherette	1	11
M5100-11241	R.A. leatherette	1	10
M5100-11251	R.A. leatherette	1	11
M5100-11261	R.A. leatherette	1	11
M5100-11271	R.A. leatherette	1	10
M5100-11281	R.A. leatherette	1	11
M5100-11501	Shaft	1	9
M5100-11511	Cocking lever	1	2
M5100-11551	Pin	1	9
M5100-11611	Spring	1	9
M5100-11631	Anchor	1	9
M5100-11641	Disk	1	2
M5100-11701	Winding base plate	1	9
M5100-11731	Sealing strip	1	9
M5100-11761	Screw	1	8
M5100-1191T1	Winding gear	1	9
M5100-11941	Shoulder screw	1	9
M5100-11951	Spring	1	9
M5100-1196T1	Ratchet gear	1	9
M5100-12311	Coupler	1	9
M5100-12321	Ring	1	4
M5100-12391	Washer	2	9
M5100-1253T1	Lever	1	9
M5100-12571	Spring	1	9
M5100-12581	Shoulder screw	1	9
M5100-12671	Coupler	1	9

Parts No.	Description	Pcs.	Ref. Page
M5100-12681	Spring	1	9
M5100-12771	Spring	1	9
M5100-13141	Spring	1	11
M5100-13281	R-M lever	1	2
M5100-13291	Screw	1	2
M5100-13511	Lock lever	1	9
M5100-13521	Shoulder screw	1	9
M5100-13531	Spring	1	9
M5100-13541	Shaft	1	11
M5100-1355T1	Bar	1	9
M5100-13611	No.2 R lever	1	9
M5100-13631	Shoulder screw	2	8,9
M5100-13651	Pawl	1	9
M5100-13671	Spring	1	9
M5100-13681	Screw	1	9
M5100-1371T1	Winding stop lever	1	9
M5100-13771	Spring	1	9
M5100-13801	Winding stop SW.	1	9
M5100-13841	Base plate	1	9
M5100-13871	Collar	1	9
M5100-14161	Spring	1	9
M5100-14381	Spring	1	9
M5100-14011	Bar	1	9
M5100-14401	R lever	1	9
M5100-1456T1	Change-over lever	1	11
M5100-14581	Shaft	1	11
M5100-14591	Screw	1	9
M5100-14611	Spring	1	9
M5100-1462T1	Change-over lever	1	11
M5100-14641	Spring	1	9
M5100-1481T1	Buzzer	1	9
M5100-14841	Distance scale	1	6
M5100-14871	Leaf spring	1	9
M5100-15011	R cover	1	8
M5100-15021	Sector gear	1	8

Parts No.	Description	Pcs.	Ref. Page
M5100-15201	Base plate	1	8
M5100-15291	Sealing strip	1	8
M5100-15401	Disk	1	8
M5100-15431	Spring	1	8
M5100-15461	Anchor	1	8
M5100-15471	Ring	1	8
M5100-15511	Sector gear	1	8
M5100-15541	Hub	1	8
M5100-1556T1	Mirror raising lever	1	8
M5100-15581	Stopper	1	8
M5100-15591	Shoulder screw	1	8
M5100-15601	Pawl	1	8
M5100-15651	Shoulder screw	1	8
M5100-15661	Spring	1	8
M5100-15681	Anchor	1	8
M5100-15691	Spring	1	8
M5100-15701	Idle gear	1	8
M5100-15751	Screw	1	8
M5100-15801	Set SW.	1	8
M5100-1611T1	Return SW.	1	8
M5100-16301	Link lever	1	8
M5100-16331	Spring	1	8
M5100-16361	Shoulder screw	1	8
M5100-16371	Hub	1	8
M5100-1642T1	Holder	1	8
M5100-16481	Anchor	1	8
M5100-16501	Mirror holder	1	10
M5100-16511	Mirror	1	10
M5100-16621	Collar	1	10
M5100-16661	Collar	1	10
M5100-16711	Paper	1	10
M5100-16721	Sealing strip	2	10
M5100-16731	Holder (R)	1	10
M5100-16741	Holder (L)	1	10
M5100-16781	Shaft	1	10

Parts No.	Description	Pcs.	Ref. Page
M5100-16791	Hub	2	10
M5100-16811	Spring	1	8
M5100-16821	Shaft	1	8
M5100-16831	Screw	1	8
M5100-16861	Collar	2	8
M5100-16881	Sealing strip	1	10
M5100-17101	Light baffle plate	1	10
M5100-17161	Collar	1	10
M5100-17171	Screw	1	10
M5100-17181	Light baffle	1	4
M5100-17191	Light baffle	1	11
M5100-17211	Spring	2	10
M5100-17221	Light baffle	1	10
M5100-17231	Light baffle	1	10
M5100-17291	Light baffle	1	8
M5100-1731T1	Rack plate (R)	1	6
M5100-1732T1	Rack plate (L)	1	6
M5100-17341	Guide plate (R)	1	8
M5100-17351	Guide plate (L)	1	9
M5100-17381	Stopper	2	5
M5100-17391	Sealing strip	1	8
M5100-17411	Pinion shaft	1	9
M5100-17431	Pipe	1	9
M5100-17451	Hold plate	2	6
M5100-17461	Holder	2	6
M5100-17491	Sealing strip	1	9
M5100-17511	Fixing lever	1	3
M5100-17571	Stopper pin	1	8
M5100-17581	Rubber grip	2	2,3
M5100-17591	Decoration disk	2	2,3
M5100-17611	Knob	2	2,3
M5100-17631	Disk	2	2,3
M5100-17651	Strap lug	2	8,11
M5100-17681	Hold plate	1	8
M5100-17711	Panel	1	2

Parts No.	Description	Pcs.	Ref. Page
M5100-17721	Screw	2	2,3
M5100-17731	Screw	7	2,3
M5100-1774T1	Side panel	1	2
M5100-17791	Cap	4	2,3
M5100-17811	Panel	1	3
M5100-1784T1	Side panel	1	3
M5100-17911	Accessory shoe	1	3
M5100-17931	Shoe cover	1	3
M5100-1811T1	Shutter speed dial	1	3
M5100-18141	Spring	1	3
M5100-18151	Disk	1	3
M5100-18171	Decoration disk	1	3
M5100-18211	Spring	1	3
M5100-18231	Click prite	1	3
M5100-1825T1	Coupler	1	3
M5100-18261	Coupler	1	3
M5100-18361	Sealing strip	1	3
M5100-18371	Sealing strip	1	3
M5100-18381	Sealing strip	1	3
M5100-18391	Sealing strip	1	3
M5100-18651	Sealing strip	1	7
M5100-18661	Light baffle	1	7
M5100-18711	Holder	1	7
M5100-18721	Cushion	1	7
M5100-18731	Shoulder screw	1	7
M5100-18761	Cover	1	8
M5100-18831	Pin	1	3
M5100-18861	Cushion	2	3
M5100-18871	Cushion	1	2
M5100-21101	Base plate	1	12
M5100-21221	Spring	1	12
M5100-21441	Spring	1	12
M5100-21571	Spring	1	12
M5100-21591	Cushion	3	7,12
M5100-2161T1	C lever	1	12

Parts No.	Description	Pcs.	Ref. Page
M5100-21651	Spring	1	12
M5100-21701	R. lever	1	12
M5100-21731	Shoulder screw	1	12
M5100-21751	Spring	1	12
M5100-21811	Shutter release button	1	12
M5100-2182T1	Shutter button collar	1	12
M5100-21841	Button holder	1	12
M5100-21851	Shaft	1	12
M5100-21861	Cam	1	12
M5100-2211T1	Release lever base	1	12
M5100-22161	Collar	1	12
M5100-22181	Spring	1	12
M5100-22191	Spring	1	12
M5100-2222T1	Collar stop lever	1	12
M5100-22261	Spring	1	12
M5100-22271	Stopper	1	12
M5100-2231T1	Release SW.	1	12
M5100-2241T1	Power SW. contact (S)	1	12
M5100-22421	Power SW. contact (L)	1	12
M5100-2261T1	MC	1	12
M5100-22811	RC stand	1	12
M5100-22841	RC guide	1	12
M5100-22851	RC cover	1	12
M5100-2289T1	RC outlet	1	12
M5100-23201	S4 SW.	1	12
M5100-23271	Shaft	3	12
M5100-2331T1	Battery case	1	7
M5100-23441	Ribbon	1	7
M5100-23511	Battery chamber cover	1	2
M5100-23521	Spring	1	2
M5100-23601	No.2 W gear	1	12
M5100-23631	Shaft	1	12
M5100-23651T1	Pedestal	1	12
M5100-23671	Winder coupler cover	1	2
M5100-23681	Leaf spring	1	2

Parts No.	Description	Pcs.	Ref. Page
M5100-23811	Bevel gear	2	12
M5100-23821	Shaft	1	12
M5100-23831	Screw	1	12
M5100-2386T1	Pedestal	1	12
M5100-23911	Spring	1	12
M5100-23921	Anchor	1	12
M5100-23931	Anchor	1	12
M5100-23951T1	Pedestal	1	12
M5100-24111	Bottom cover	1	2
M5100-24121	No. plate	1	2
M5100-24141	Tripod screw	1	2
M5100-24151	Cover	1	2
M5100-24171	Screw	5	2
M5100-24181	Screw	1	2
M5100-24191	Screw	1	2
M5100-24211	Sealing strip	1	7
M5100-24221	Sealing strip	1	2
M5100-24231	Sealing strip	1	2
M5100-25111	FH hanger	1	4
M5100-25131	FH hanger	1	4
M5100-25141	Pin	2	11
M5100-2521T1	Light baffle	1	11
M5100-2522T1	Light baffle	1	11
M5100-25241	Sealing strip	2	11
M5100-25251	Sealing strip	4	11
M5100-25281	Sealing strip	4	11
M5100-25291	Sealing strip	2	10
M5100-25311	Mask (V)	2	11
M5100-25321	Shaft	2	11
M5100-25331	Frame	2	11
M5100-25341	Frame	2	11
M5100-25411	Mask (F)	1	11
M5100-25421	Mask (R)	1	11
M5100-25451	Screw	4	11
M5100-25511	Screw	3	11

Parts No.	Description	Pcs.	Ref. Page
M5100-25611	Finder screen catcher	2	11
M5100-25631	Finder screen catcher	1	11
M5100-25681	Screw	2	7
M5100-3111T1	Bellows	1	6
M5100-31171	Cover	1	10
M5100-31181	Sealing strip	1	6
M5100-31211	Front panel	1	6
M5100-3123T1	Bayonet	1	5
M5100-31261	Stopper	1	5
M5100-31311	Lock lever	1	5
M5100-31321	Shoulder screw	1	5
M5100-31331	Spring	1	5
M5100-31341	Cocking ring	1	5
M5100-31371	Retaining ring	1	5
M5100-31411	Signal pin	12	5
M5100-31421	Leaf spring	12	5
M5100-31431	Signal pins housing	1	5
M5100-31451	Bayonet FPC	1	5
M5100-31461	Bayonet FPC	1	5
M5100-31481	Back plate	1	5
M5100-31511	Fitting plate	1	6
M5100-3154T1	Cocking gear unit	1	6
M5100-31711	Hold plate	1	5
M5100-31731	Fitting plate	1	5
M5100-32101	Governor	1	6
M5100-32351	Stopper screw	2	6
M5100-3241T1	Front cover	1	3
M5100-32431	Screw	10	3,6
M5100-32451	Focal length scale	1	3
M5100-35101	ASA pins housing unit	1	4
M5100-35111	Stopper	1	12
M5100-35151	ASA signal pin	4	4
M5100-35161	Spring	4	4
M5100-35171	Signal pins housing	1	4
M5100-35211	Cover	1	4

Parts No.	Description	Pcs.	Ref. Page
M5100-35301	Monitor lamp unit	1	4
M5100-35351	LED prism	1	11
M5100-35391	Cover	1	11
M5100-35471	Fitting plate	1	4
M5100-35501	VM lever	1	4
M5100-35531	Shoulder screw	2	4
M5100-35541	Spring	1	4
M5100-35551	Anchor	1	4
M5100-35571	Switch pin	2	4
M5100-35581	Collar	1	4
M5100-35591	Collar	1	4
M5100-35601	Revolving ring	1	4
M5100-35611	Base plate	1	4
M5100-35621	Screw	4	4
M5100-35641	Sealing strip	2	4
M5100-35711	Click plate	1	4
M5100-35721	Roller	1	4
M5100-35731	Leaf spring	1	4
M5100-35751	Fitting ring	1	4
M5100-35761	Screw	14	4
M5100-35781	Light baffle	2	4
M5100-36101	F.P.C board	1	7
M5000-13321	Antifriction	2	8
M1180-81441	Lug plate	2	8,9
aRS1483	Leaf spring	1	3
aRS1486	Ring	1	3
aRS1528	Screw	8	6,8,9
RS1172	Fixing nut	2	23
RS1524	Pipe	1	8
RS2112	Sealing strip	1	5
RS2135	Spacar	13	5
RS2443K2	Stop lever	1	8
RS2446	Spring	1	8
FC4662	Nut	2	2,3
SLS11681	Stopper piece	5	6,11

Parts No.	Description	Pcs.	Ref. Page
SLT16821	Seal	1	2
PB1.4x1.5	Screw for M5100-16731	2	10
	for M5100-16741	2	10
	for M5100-31731	2	5
PB1.4x2	Screw for M5100-14011	1	9
	for M5100-2222T1	2	12
PB1.7x1.5	Screw for M5100-17681	2	8
	for M5100-18711	1	7
	for M5100-18761	2	8
PB1.7x2	Screw for M5100-23521	1	2
	for M5100-23681	1	2
	for M5100-3111T1	9	6
	for M5100-35301	2	4
	for M5100-35391	3	11
	for M5100-35471	2	4
	for aRS1483	1	3
	for RS2443K2	2	8
PB1.7x2.5	Screw for M5100-11161	2	10
	for M5100-11701	9	9
	for M5100-13841	1	9
	for M5100-14871	2	9
	for M1180-81441	2	7,8
	for M5100-1774T1	5	2
	for M5100-17841T1	4	3
	for M5100-21101	5	12
	for M5100-21841	1	12
	for M5100-2211T1	1	12
	for M5100-31421	5	5
	for M5100-31511	1	6
	for M5100-3154T1	2	6
	for M5100-31711	2	5
	for M5100-32101	3	6
	for M5100-35101	1	4
	for M5100-36101	2	7

Parts No.	Description	Pcs.	Ref. Page
PB1.7x2.5Ni	Screw for M5100-36101	3	7
PB1.7x3	Screw for M5100-15011	1	8
	for M5100-17631	2	2,3
	for M5100-22271	1	12
	for M5100-2331T1	3	7
	for M5100-24151	2	2
	for M5100-25111	2	4
	for M5100-25131	2	4
	for M5100-25331	4	11
	for M5100-25341	4	11
	for M5100-25511	3	11
	for M5100-25611	5	11
	for M5100-3111T1	4	5
	for M5100-36101	1	7
PB1.7x3Ni	Screw for M5100-36101	1	7
PB1.7x3.5	Screw for M5100-15201	6	8
	for M5100-1642T1	2	8
PB1.7x4	Screw for M5100-36101	3	7
PB1.7x5	Screw for M5100-15801	1	8
	for M5100-1611T1	1	8
	for M5100-35111	2	12
PB1.7x5.5	Screw for M5100-13871	1	9
PB1.7x6	Screw for M5100-35111	2	12
PB1.7x7	Screw for M5100-23201	2	12
PB1.7x8	Screw for M5100-2211T1	1	12
	for M5100-22841	2	12
PB1.7x12	Screw for M5100-2211T1	1	12
PB2.6x3	Screw for M5100-24141	1	2
3PB1.7x2.5	Screw for M5100-1556T1	4	8
	for M5100-2261T1	2	12
3PB1.7x3.5	Screw for M5100-2365T1	2	12
3PB2x3	Screw for M5100-2386T1	2	12
	for M5100-2391T1	2	12
4PB1.7x2.2	Screw for M5100-1481T1	2	9

Parts No.	Description	Pcs.	Ref. Page
4PB1.7x3	Screw for M5100-16861	2	9
TB1.4x2	Screw for M5100-35211	2	4
TB1.7x3	Screw for M5100-18151	3	3
	for M5100-1825T1	1	3
	for M5100-18261	1	3
TB1.7x4.5	Screw for M5100-13801	1	9
PD1.7x2	Screw for M5100-11151	2	10
	for M5100-16371	2	8
PD1.7x2.5	Screw for M5100-15011	1	8
	for M5100-15541	2	8
	for M5100-1774T1	2	2
	for M5100-1784T1	3	3
	for M5100-31261	2	5
	for M5100-31481	2	5
	for M5100-31711	2	5
PD1.7x3.5	Screw for M5100-17451	6	6
PD1.7x4	Screw for M5100-17511	2	3
	for M5100-22161	1	12
PD1.7x5Ni	Screw for M5100-17911	4	3
PD2x5	Screw for M5100-11511	4	2
	for M5100-17341	1	8
	for M5100-17651	8	8,11
PD2.6x4.5Cr	Screw for M5100-3123T1	6	5
PD2.6x5	Screw for M5100-1731T1	3	6
	for M5100-1732T1	3	6
	for M5100-17341	2	8
	for M5100-17351	3	9
TD1.7x3.5	Screw for M5100-18231	4	3
TD1.7x4.5	Screw for M5100-2231T1	1	12
	for M5100-2241T1	1	12
E-13	E-ring	2	10
E-17	E-ring	3	9,12
CE-7	CE-ring	2	12
CE-8	CE-ring	1	12
GS1.5	GS-ring	2	7

Parts No.	Description	Pcs.	Ref. Page
4W2x0.2	Washer	4	12
6W3x0.03	Washer	0to6	5
6W3x0.05	Washer	0to6	5
6W3x0.1	Washer	0to6	5
6W3x0.2	Washer	0to6	5
12Wx6x0.2	Washer	0to2	3
BO.16	Steel ball	13	5
BO.20	Steel ball	1	3

120 ROLL FILM HOLDER RZ

(M5171)

Mamiya **RZ67** PROFESSIONAL

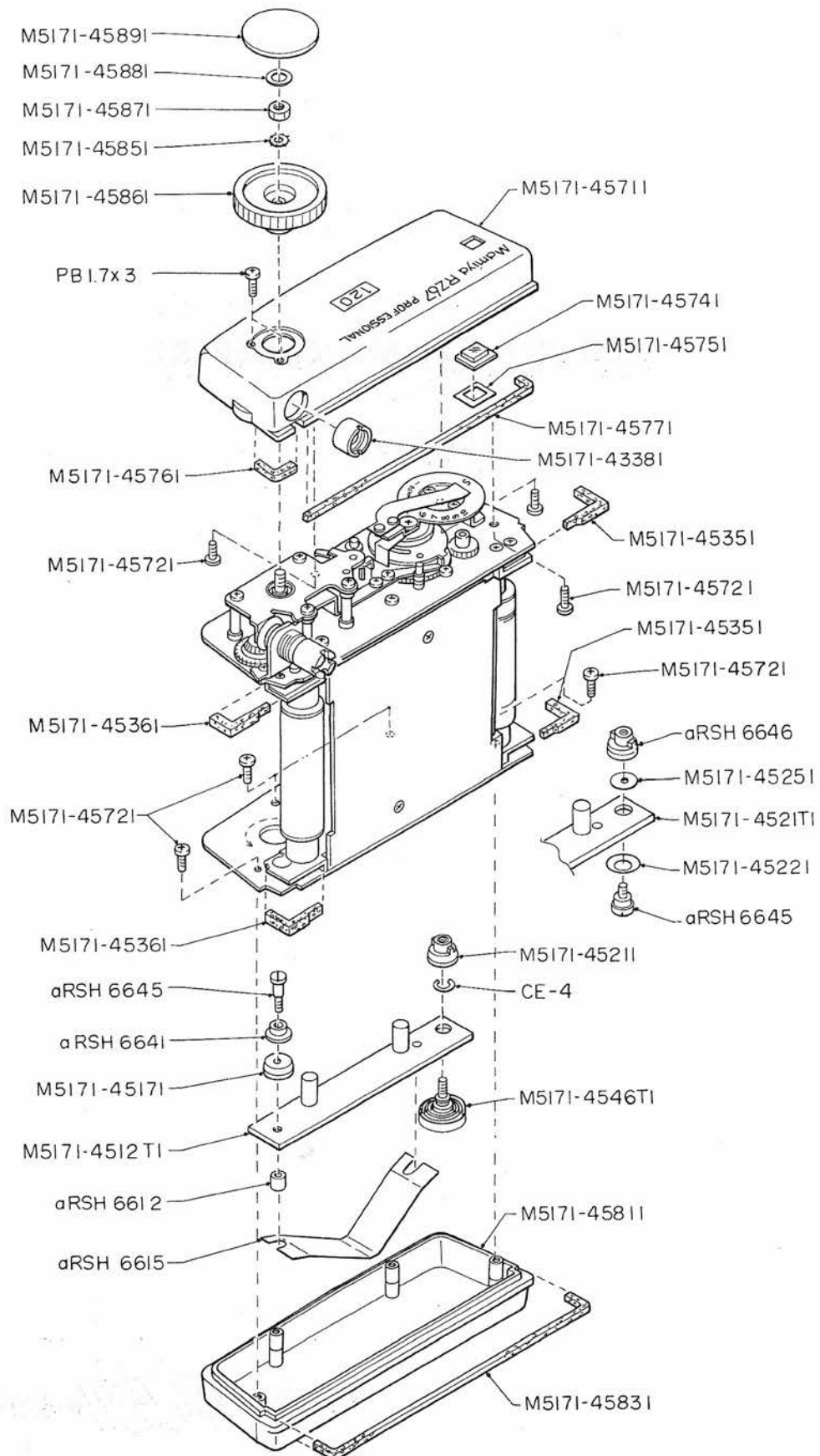

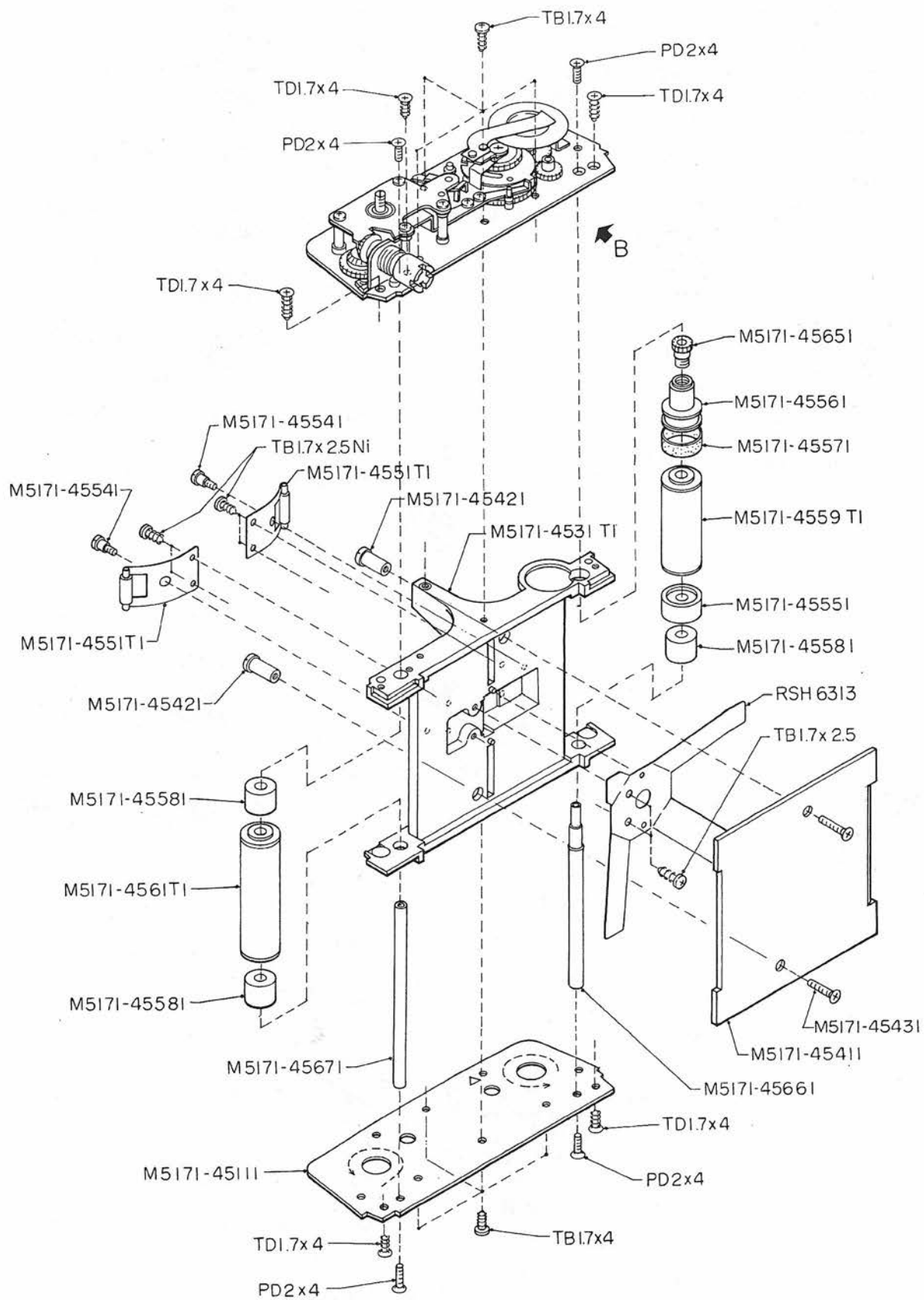

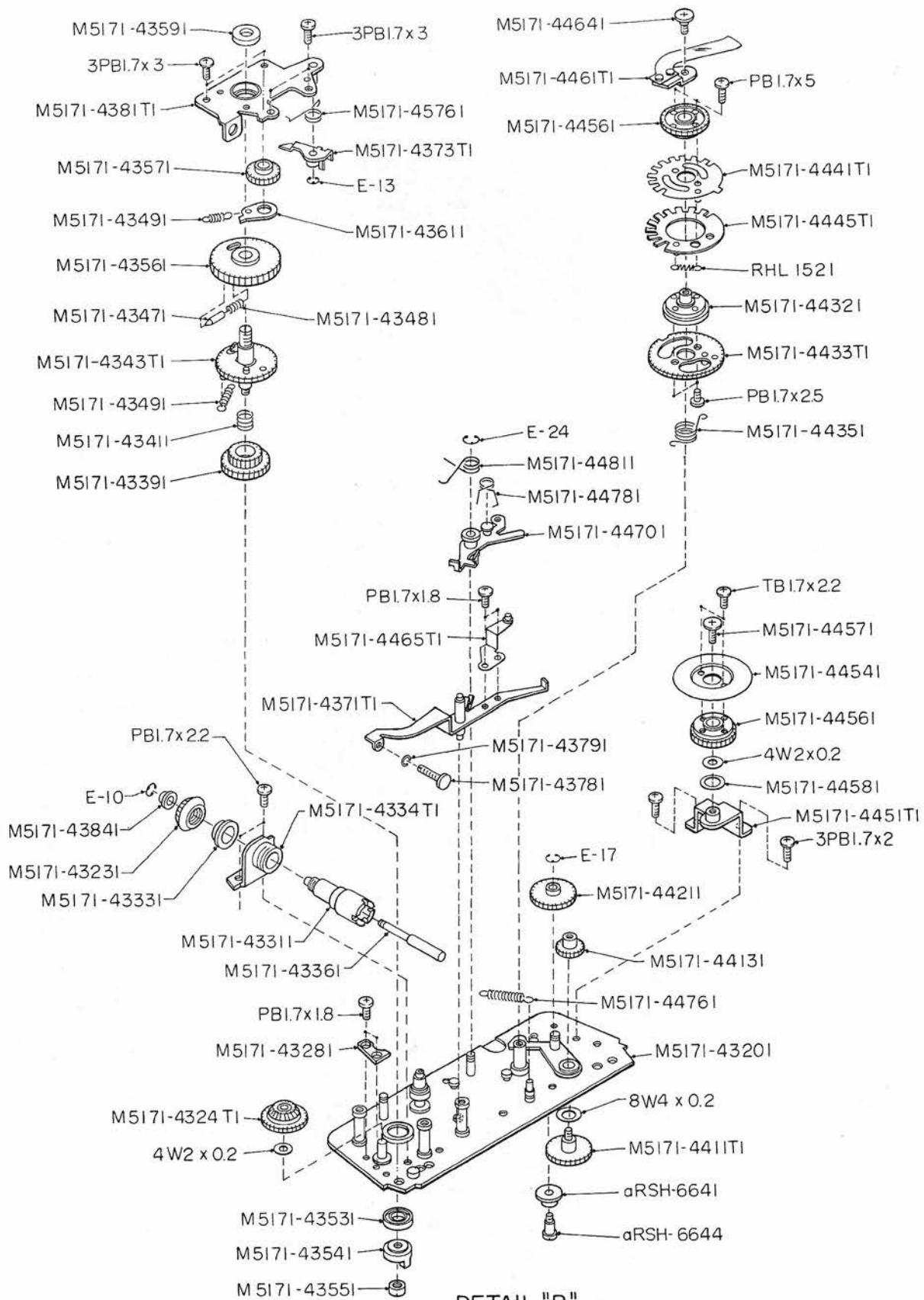

DETAIL "B"

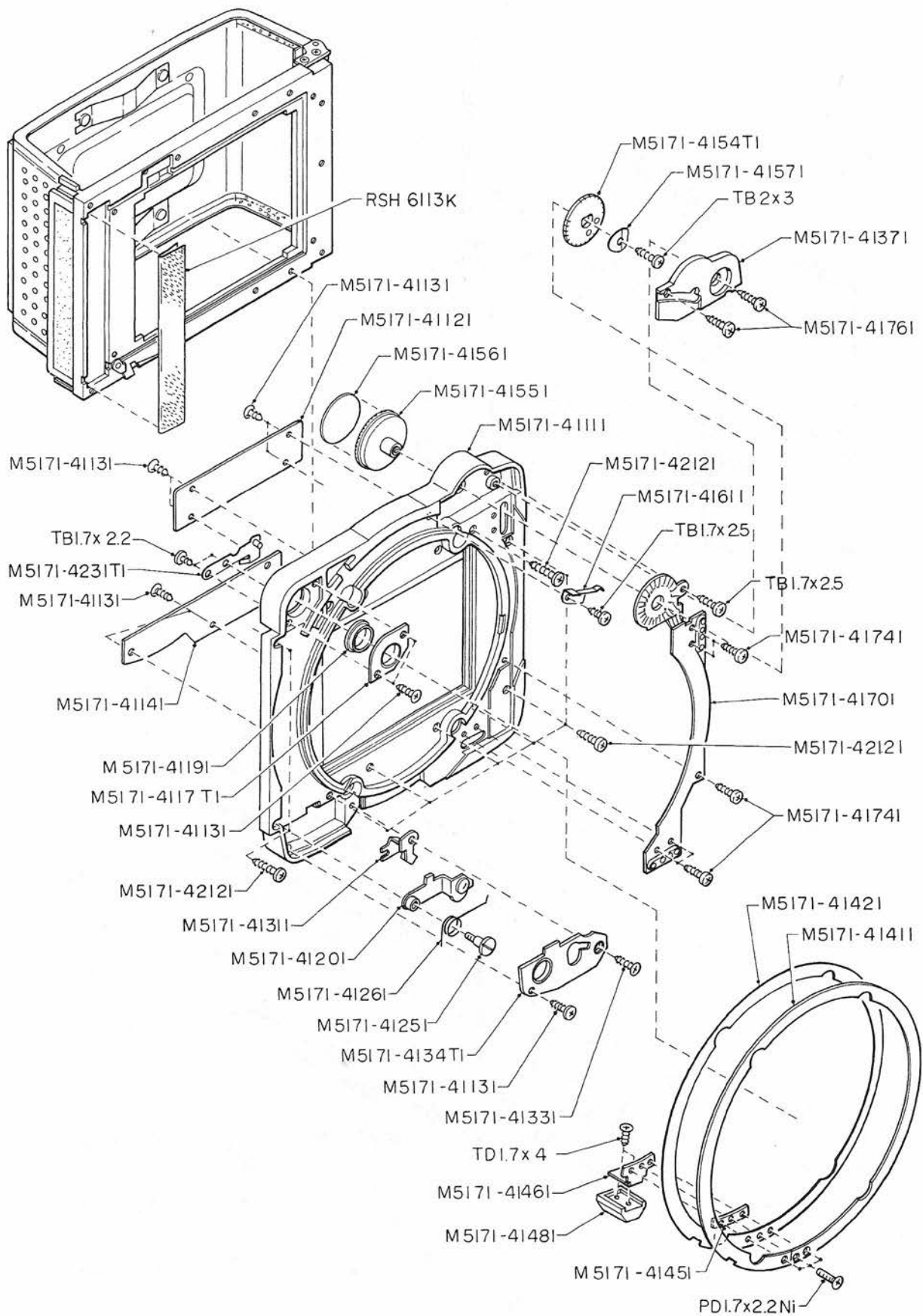

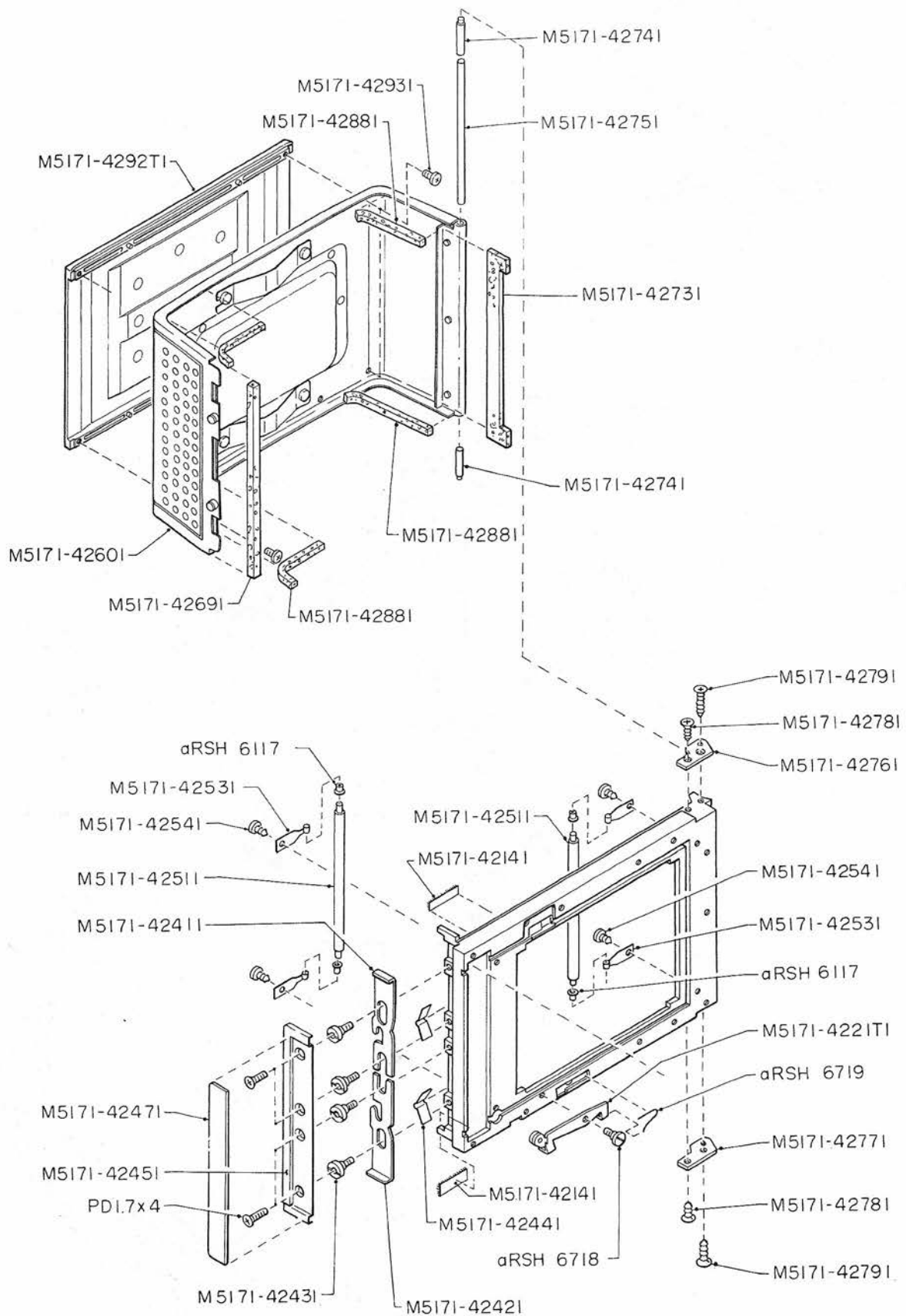

Parts No.	Description	Pcs.	Ref. Page
M5171-41111	Revolving back	1	31
M5171-41121	Cover	1	31
M5171-41131	Screw	10	31
M5171-41141	Cover	1	31
M5171-4117T1	Coupler cover	1	31
M5171-41191	Ring	1	31
M5171-41201	Lock release lever	1	31
M5171-41251	Shoulder screw	1	31
M5171-41261	Spring	1	31
M5171-41311	Lever	1	31
M5171-41331	Screw	1	31
M5171-4134T1	Cover	1	31
M5171-41411	Ring (U)	1	31
M5171-41421	Ring (L)	1	31
M5171-41461	L Plate	1	31
M5171-41481	Knob	1	31
M5171-4154T1	Contact brush	1	31
M5171-41551	Film speed dial	1	31
M5171-41561	Disk	1	31
M5171-41571	Washer	1	31
M5171-41611	Leaf spring	1	31
M5171-41701	ASA FPC board	1	31
M5171-41741	Screw	5	31
M5171-41751	ASA cover	1	31
M5171-41761	Screw	2	31
M5171-42121	Screw	1	31
M5171-42141	Light baffle	2	32
M5171-4221T1	Lever	1	32
M5171-4231T1	Lock lever	1	31
M5171-42411	Latch	1	32
M5171-42421	Latch	1	32
M5171-42431	Screw	4	32
M5171-42441	Leaf spring	2	32
M5171-42451	Cover	1	32
M5171-42471	Rubber plate	1	32

Parts No.	Description	Pcs.	Ref. Page
M5171-42511	Roller	2	32
M5171-42531	Holder	4	32
M5171-42541	Screw	4	32
M5171-42601	Back cover	1	32
M5171-42691	Sealing strip	1	32
M5171-42731	Sealing strip	1	32
M5171-42741	Shaft	2	32
M5171-42751	Shaft	1	32
M5171-42761	Hinge holder	1	32
M5171-42771	Hinge holder	1	32
M5171-42781	Screw	2	32
M5171-42791	Screw	2	32
M5171-42881	Sealing strip	4	32
M5171-4292T1	Cover	1	32
M5171-42931	Screw	4	32
M5171-43201	Winding base plate	1	30
M5171-43231	Bevel gear	1	30
M5171-4324T1	W2 gear	1	30
M5171-43281	Plate	1	30
M5171-43311	Coupler	1	30
M5171-43331	Ring	1	30
M5171-4334T1	Pedestal	1	30
M5171-43361	Shaft	1	30
M5171-43381	Nut	1	28
M5171-43391	W3 gear	1	30
M5171-43411	Spring	1	30
M5171-4343T1	Winding clutch gear	1	30
M5171-43471	Pin	1	30
M5171-43481	Spring	1	30
M5171-43491	Spring	2	30
M5171-43531	Antifriction	1	30
M5171-43541	Film spool holder	1	30
M5171-43551	Nut	1	30
M5171-43561	Winding stop gear	1	30
M5171-43571	Gear	1	30

Parts No.	Description	Pcs.	Ref. Page
M5171-43591	Collar	1	30
M5171-43611	Pawl	1	30
M5171-4371T1	Signal lever	1	30
M5171-4373T1	Winding stop lever	1	30
M5171-43761	Spring	1	30
M5171-43781	Adjust screw	1	30
M5171-43791	Washer	1	30
M5171-4381T1	Base plate	1	30
M5171-43841	Hub	1	30
M5171-4411T1	No.2 large gear	1	30
M5171-44131	No.2 small gear	1	30
M5171-44211	No.3 gear	1	30
M5171-44321	Hub	1	30
M5171-4433T1	Film counter gear	1	30
M5171-44351	Screw	1	30
M5171-4441T1	Counter dividing device	1	30
M5171-4445T1	Auxiliary dividing disk	1	30
M5171-4451T1	Pedestal	1	30
M5171-44541	Counter	1	30
M5171-44561	Counter gear	2	30
M5171-44571	Screw	1	30
M5171-44581	Washer	1	30
M5171-4461T1	Red signal	1	30
M5171-44641	Shoulder screw	1	30
M5171-4465T1	Signal arm	1	30
M5171-44701	Release lever	1	30
M5171-44761	Spring	1	30
M5171-44781	Spring	1	30
M5171-44811	Spring	1	30
M5171-45111	Base plate (L)	1	29
M5171-4512T1	Film spool holder	1	28
M5171-45171	Collar	1	28
M5171-45211	Film spool holder	1	28
M5171-4531T1	Frome	1	29
M5171-45351	Sealing strip	2	28

Parts No.	Description	Pcs.	Ref. Page
M5171-45361	Sealing strip	2	28
M5171-45411	Pressure plate	1	29
M5171-45421	Shaft	2	29
M5171-45431	Screw	2	29
M5171-4546T1	Spring	1	28
M5171-4551T1	T-spring	2	29
M5171-45541	Shoulder screw	2	29
M5171-45551	Roller	1	29
M5171-45561	Roller	1	29
M5171-45571	Rubber ring	1	29
M5171-45581	Roller	3	29
M5171-4559T1	Roller	1	29
M5171-4561T1	Roller	1	29
M5171-45651	Gear	1	29
M5171-45661	Shaft	1	29
M5171-45671	Shaft	1	29
M5171-45711	Top cover	1	28
M5171-45721	Screw	7	28
M5171-45741	Window	1	28
M5171-45751	Mask	1	28
M5171-45761	Sealing strip	1	28
M5171-45771	Sealing strip	1	28
M5171-45811	Bottom cover	1	28
M5171-45831	Sealing strip	1	28
M5171-45851	Washer	1	28
M5171-45861	Film advance knob	1	28
M5171-45871	Nut	1	28
M5171-45881	Washer	1	28
M5171-45891	Disk	1	28
aRSH6117	Collar	4	32
aRSH6612	Collar	1	28
aRSH6615	Leaf spring	1	28
aRSH6641	Film spool holder	2	28, 30
aRSH6644	Shoulder screw	1	30
aRSH6645	Shoulder screw	1	28

Parts No.	Description	Pcs.	Ref. Page
aRSH6718	Screw	1	32
aRSH6719	Spring	1	32
RSH6113K	Spring	1	31
RSH6313	Spring	1	29
RHL1521	Spring	1	30
PB1.7x1.8	Screw for M5171-43281	2	30
	for M5171-44651	2	30
PB1.7x2.2	Screw for M5171-4334T1	2	30
PB1.7x2.5	Screw for M5171-4433T1	2	30
PB1.7x3	Screw for M5171-45711	2	28
PB1.7x5	Screw for M5171-44561	2	30
3PB1.7x2	Screw for M5171-4451T1	2	30
3PB1.7x3	Screw for M5171-4381T1	4	30
TB1.7x2.2	Screw for M5171-4231T1	2	31
	for M5171-44571	2	30
TB1.7x2.5	Screw for M5171-41611	1	31
TB1.7x2.5	Screw for M5171-41701	1	31
	for RSH6313	2	29
TB1.7x2.5Ni	Screw for M5171-4551T1	4	31
TB1.7x4	Screw for M5171-43201	4	29
	for M5171-45111	4	29
TB2x3	Screw for M5171-4154T1	1	31
PD1.7x2.2Ni	Screw for M5171-41461	3	31
PD1.7x4	Screw for M5171-42451	4	32
PD2x4	Screw for M5171-45661	2	29
	for M5171-45671	2	29
TD1.7x4	Screw for M5171-41481	2	31
	for M5171-43201	3	29
	for M5171-45111	2	29
4W2x0.2	Washer	2	30
8W4x0.2	Washer	1	30
E-10	E-ring	1	30
E-13	E-ring	1	30
E-17	E-ring	1	30
E-24	E-ring	1	30
CE-4	CE-ring	1	28

220 ROLL FILM HOLDER RZ

(M5172)

The parts with P.ID Number "M5172" are
exclusive use for the 220 type.

Mamiya **RZ67** PROFESSIONAL

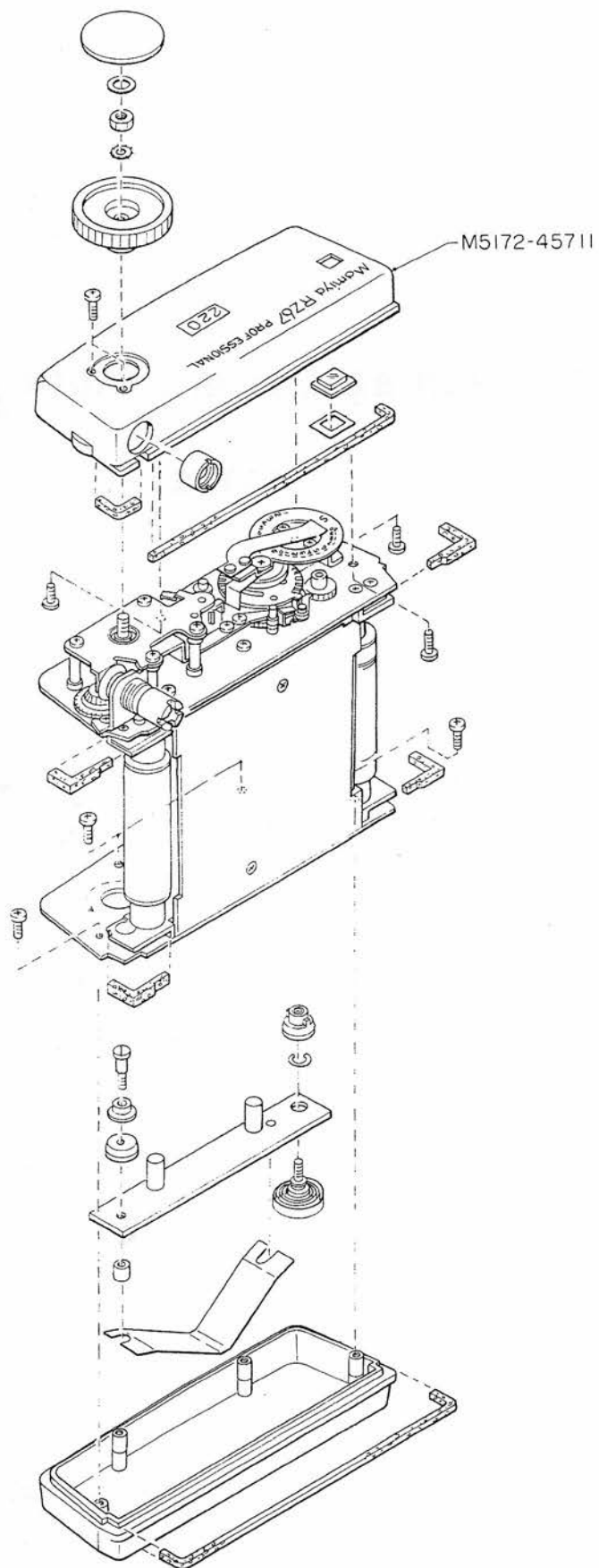

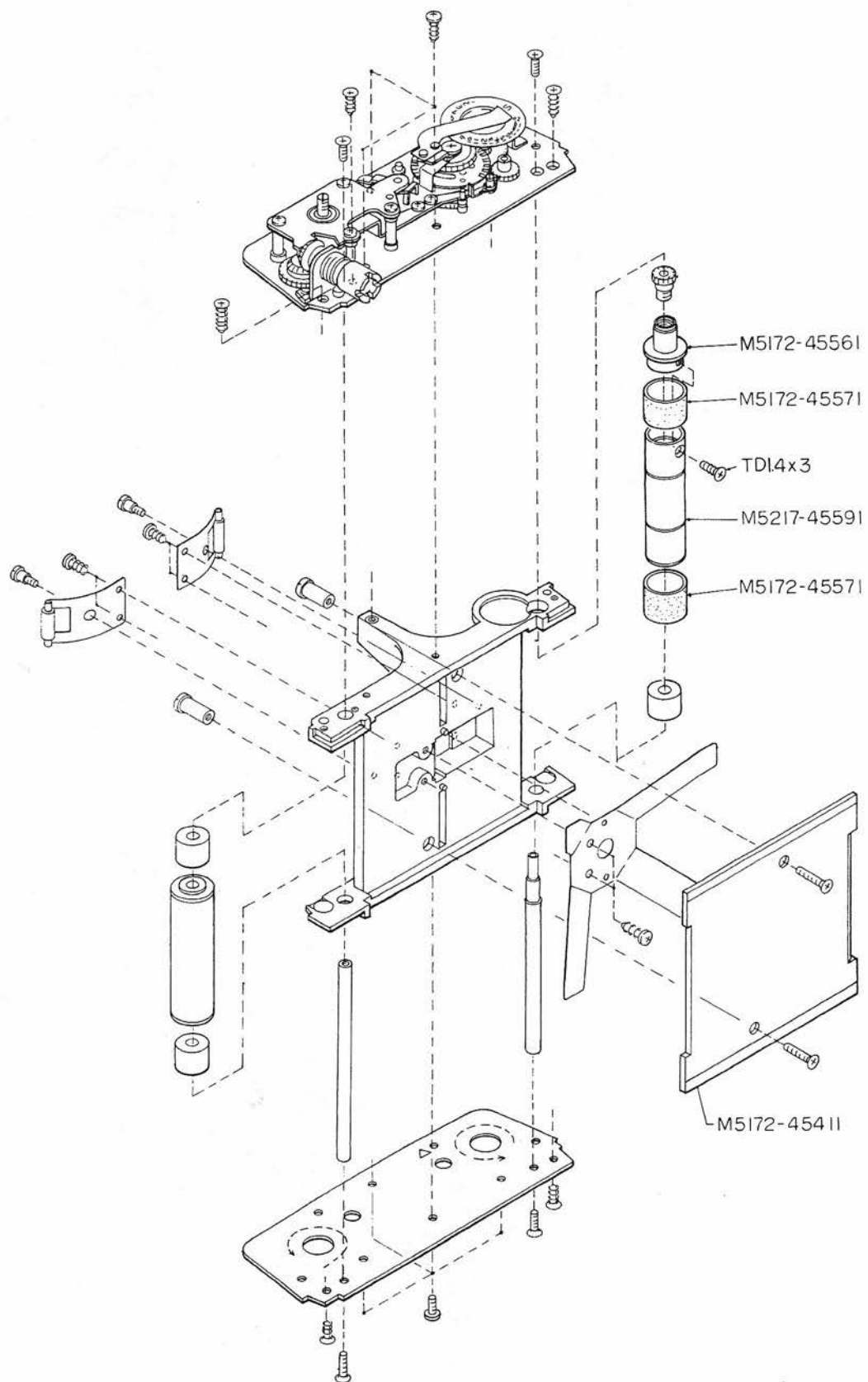

Parts No.	Description	Pcs.	Ref. Page
M5172-43201	Winding base plate	1	42
M5172-44131	No.2 small gear	1	42
M5172-44211	No.3 gear	1	42
M5172-4433T1	Film counter gear	1	42
M5172-4441T1	Counter dividing device	1	42
M5172-4445T1	Auxiliary dividing disk	1	42
M5172-44541	Counter	1	42
M5172-45351	Stopper	1	42
M5172-45361	Shaft	1	42
M5172-45371	Spring	1	42
M5172-45411	Pressure plate	1	41
M5172-45561	Roller	1	41
M5172-45571	Rubber ring	2	41
M5172-45591	Roller	1	41
M5172-45711	Top cover	1	40
TD1.4x3	Screw for M5172-45561	1	41
2.8W1.8x0.1	Washer	1	42
E-13	E-ring	1	42

FOCUSING HOOD RZ

(M5100-2600)

Mamiya **RZ67** PROFESSIONAL

Focusing hood RZ

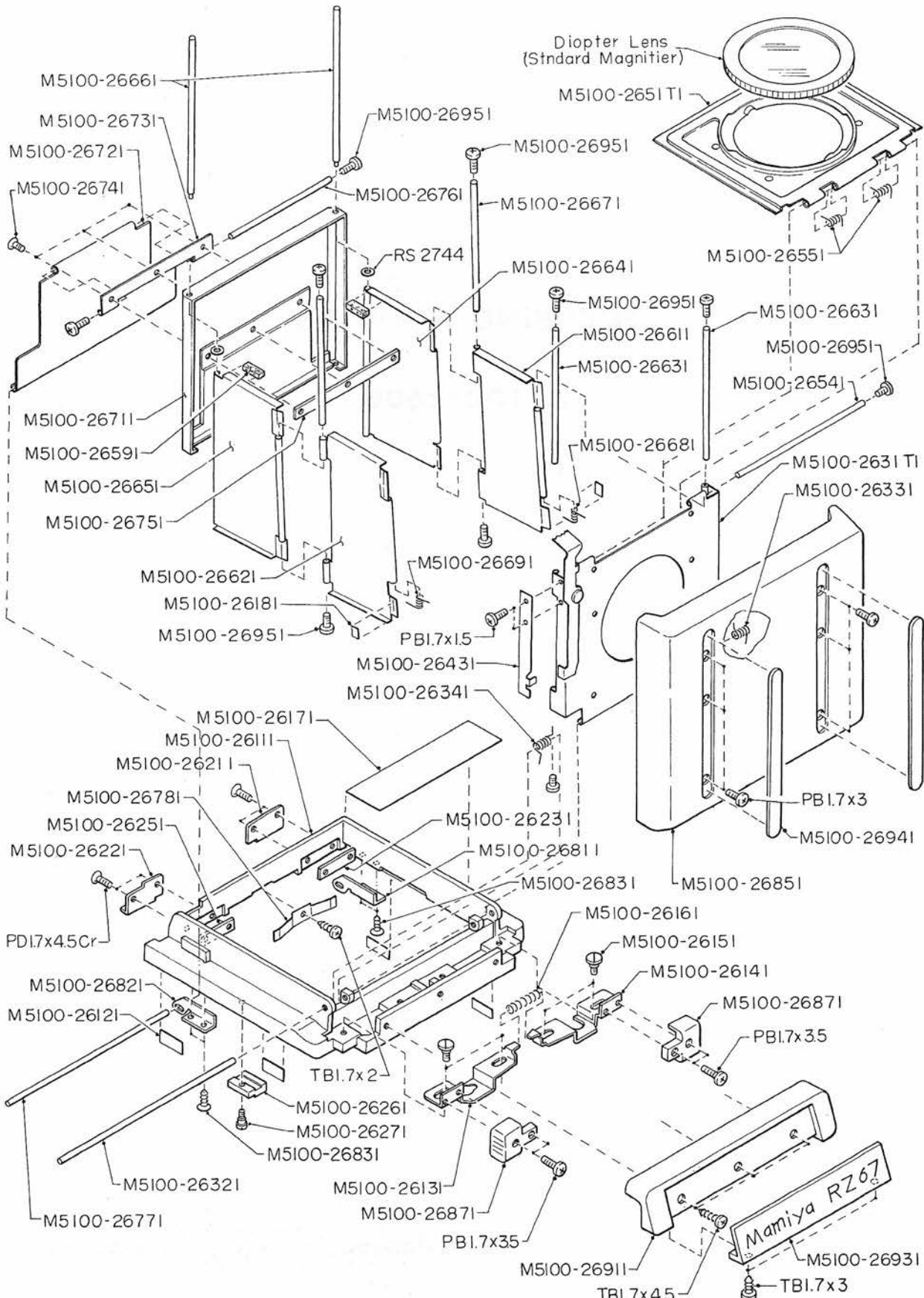

Parts No.	Description	Pcs.	Ref. Page
M5100-26111	FH base frame	1	46
M5100-26121	Sealing strip	4	46
M5100-26131	Lock lever (R)	1	46
M5100-26141	Lock lever (L)	1	46
M5100-26151	Shoulder screw	4	46
M5100-26161	Spring	1	46
M5100-26171	Light baffle	1	46
M5100-26181	Tape	2	46
M5100-26211	Fitting plate (R)	1	46
M5100-26221	Fitting plate (L)	1	46
M5100-26231	Holder (R)	1	46
M5100-26251	Holder (L)	1	46
M5100-26261	P holder	1	46
M5100-26271	Shoulder screw	1	46
M5100-2631T1	Front frame	1	46
M5100-26321	Shaft	1	46
M5100-26331	Spring	1	46
M5100-26341	Spring	1	46
M5100-26431	Leaf spring	1	46
M5100-2651T1	Magnifying frame	1	46
M5100-26541	Shaft	1	46
M5100-26551	Spring	2	46
M5100-26591	Sealing strip	2	46
M5100-26611	Side pamel (R)	1	46
M5100-26621	Side pamel (L)	1	46
M5100-26631	Shaft	2	46
M5100-26641	Side pamel (R)	1	46
M5100-26651	Side pamel (L)	1	46
M5100-26661	Shaft	2	46
M5100-26671	Shaft	2	46
M5100-26681	Spring	1	46
M5100-26691	Spring	1	46
M5100-26711	Rear pamel	1	46
M5100-26721	Flap plate	1	46
M5100-26731	Hinge plate	1	46

Parts No.	Description	Pcs.	Ref. Page
M5100-26741	Screw	3	46
M5100-26751	Holder	1	46
M5100-26761	Shaft	1	46
M5100-26771	Shaft	1	46
M5100-26781	Leaf spring	1	46
M5100-26811	Pedestal (R)	1	46
M5100-26821	Pedestal (L)	1	46
M5100-26831	Screw	4	46
M5100-26851	Hood cover	1	46
M5100-26871	Knob	2	46
M5100-26911	Frame	1	46
M5100-26931	Name plate	1	46
M5100-26941	Rubber	2	46
M5100-24951	Screw	12	46
RS2744	Washer	2	46
PB1.7x1.5	Screw for M5100-26431	2	46
PB1.7x2	Screw for M5100-26781	1	46
PB1.7x3	Screw for M5100-26851	6	46
PB1.7x3.5	Screw for M5100-26871	4	46
PD1.7x4.5Cr	Screw for M5100-26221	2	46
	for M5100-26211	2	46
TB1.7x3	Screw for M5100-26931	2	46
TB1.7x4.5	Screw for M5100-26911	3	46